

# BS-2

## Capacity

150 - 300 - 500 - 750 - 1000 kg



Certificate  
N° E-98.02.C03

Up to 4000 divisions OIML-R60

Fully stainless steel

Protected against humidity IP-67  
(EN 60529)

Platform up to 800x800 mm

High accuracy with off-center loads

## Technical Data

Accuracy class	C3-C4
Rated output	$2 \pm 10\%$ mV/V
Vmin	Emax/10000
Excitation Voltage	5÷15 V
Input Resistance	$390 \pm 3$
Output resistance	$350 \pm 3$
Temperature limits OIML R60	-10° C / +40° C
Insulation resistance	> 5000 M

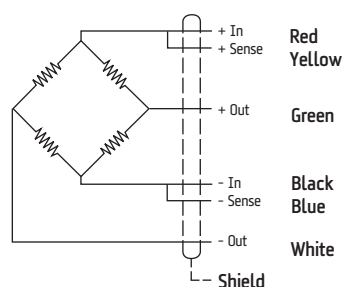
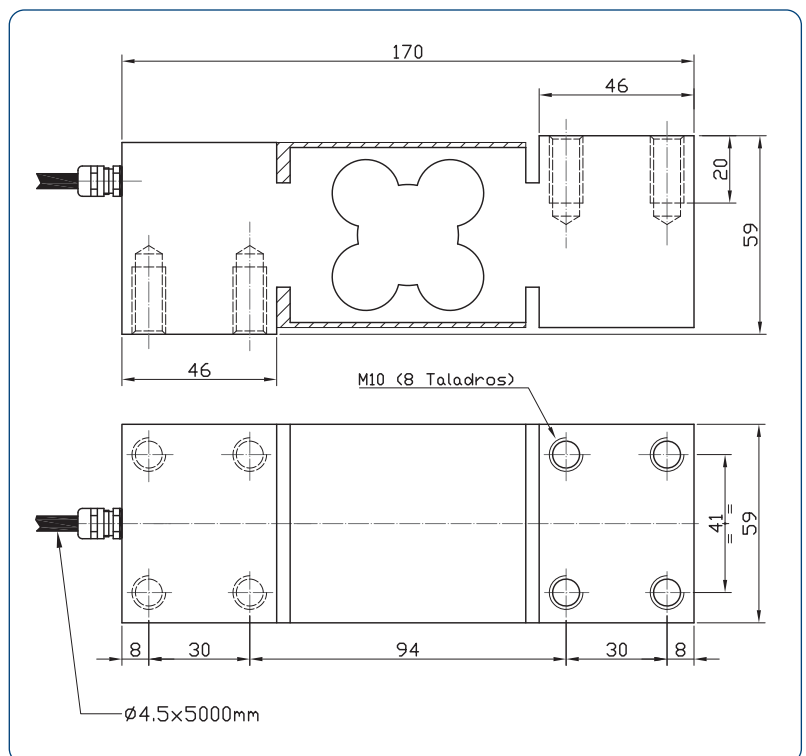

**SENSOCAR**

Tel.: 34 93 780 44 99

Fax: 34 93 780 39 72

[www.sensocar.com](http://www.sensocar.com)

[comercial@sensocar.com](mailto:comercial@sensocar.com)

**Connections**

Optional Sense